

## **BMS B48/B58 BMW Competition Cold Air Intake Install Guide**

Last updated 3/29/2024

Use subject to terms and conditions posted at <https://burgertuning.com/pages/terms>

THIS PART IS LEGAL FOR USE ONLY IN COMPETITION RACING VEHICLES AS DEFINED UNDER CALIFORNIA LAW AND IS NOT LEGAL FOR USE IN ANY OTHER MOTOR VEHICLE. California law defines a "racing vehicle" as "a competition vehicle not used on public highways." (Calif. Health & Safety Code 39048) This part may only be used on competition racing vehicles operated exclusively on a closed course in conjunction with a sanctioned racing event. Competition-only motor vehicles may not be driven to a racing event on a public highway and must be transported on a trailer or other carrier. USE OF THIS PART IN ANY OTHER VEHICLE MAY SUBJECT YOU TO FINES AND PENALTIES FOR VIOLATION OF FEDERAL AND/OR STATE LAW, WILL VOID YOUR WARRANTY FROM BURGER MOTORSPORTS, INC, AND CAN VOID YOUR VEHICLE'S WARRANTY. It is your responsibility to comply with all applicable federal and state laws relating to the use of this part, and Burger Motorsports, INC hereby disclaims any liability resulting from the failure to use this part in compliance with all applicable federal and state laws.



### Tools Needed:

- Flat head screwdriver or 8mm socket (loosen/tighten/remove hose clamps)
- Phillips head screwdriver (Tighten included "MAF" temperature sensor screws)
- T15 Torx (removing factory "MAF" temperature sensor and heat shield)
- 1/4" or 4mm Allen hex wrench (Installing air box lid and factory heat shield)

Intake designed to work with OEM or [BMS Billet Strut Braces](#) and the [BMS B58 Oil Catch Can](#).

**!** **Attention:** Factory coarse thread screws will not be reused on the BMS intake. Keep these with your factory intake for safe keeping. Be sure the engine is cold before you start so you don't burn yourself and the radiator fan doesn't turn on and cause an injury.



1. Unplug the “MAF” temperature sensor by popping out the gray clip, pinching and pulling.
2. Loosen the upper factory hose clamp on the rubber accordion intake outlet tube.





3. Remove the factory intake by pulling up on it.
4. Be sure the 3 rubber supports are still in place. They may become dislodged during the removal of the factory intake.
5. Remove the rubber accordion intake outlet tube by removing the lower clamp by prying it apart and twisting with a flat head screwdriver in between the pinched area. It may take some force.

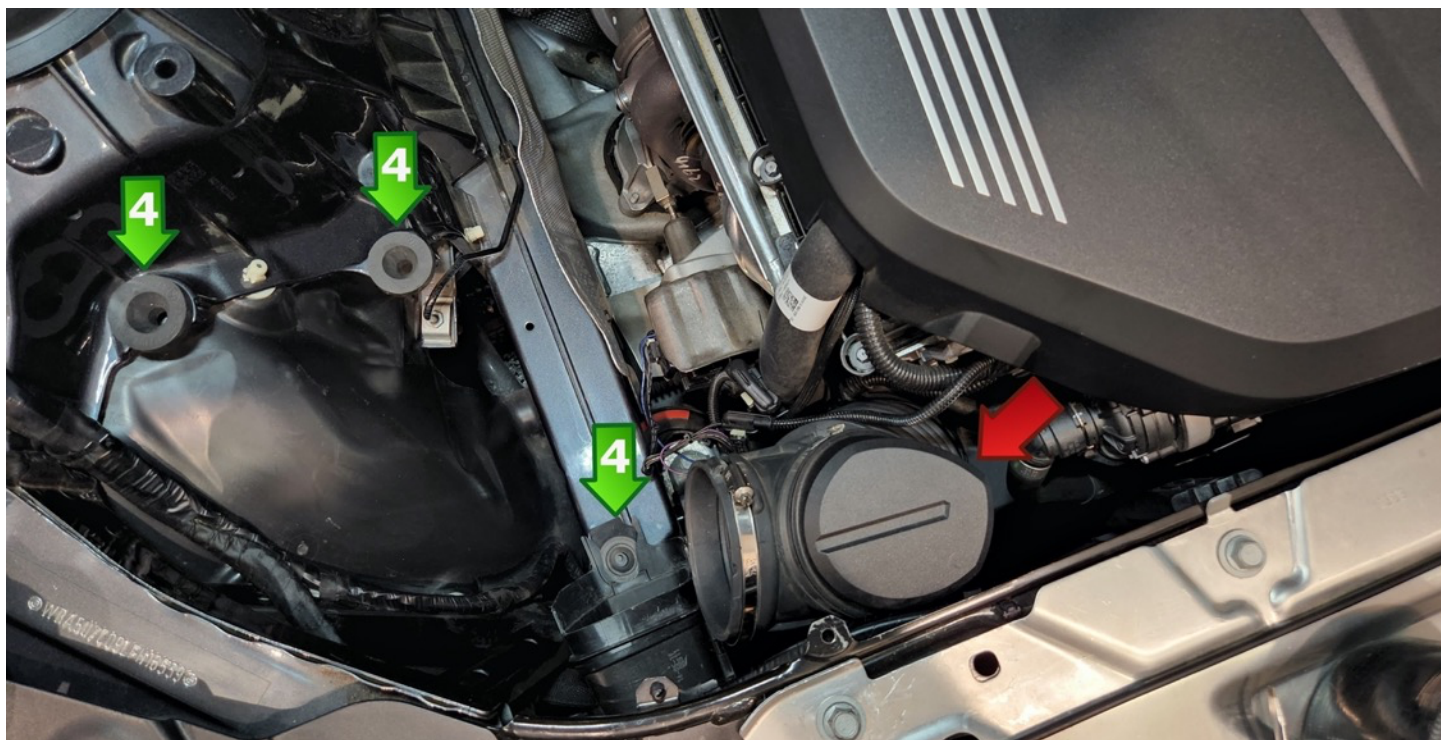

6. Using a T15 Torx tool remove the “MAF” temperature sensor from the factory intake. Place the factory bolts back in the factory intake for safe keeping. They will not be used. Now add the “MAF” sensor to the BMS intake tube using the 2 supplied Phillips head screws.





7. Using a T15 Torx tool remove the factory heat shield. Place the torx bolts back in the factory intake For safe keeping. Next attach the factory heat shield to the BMS intake using the 4 supplied hex head bolts. Add the supplied weather stripping to the round hole in the BMS intake.

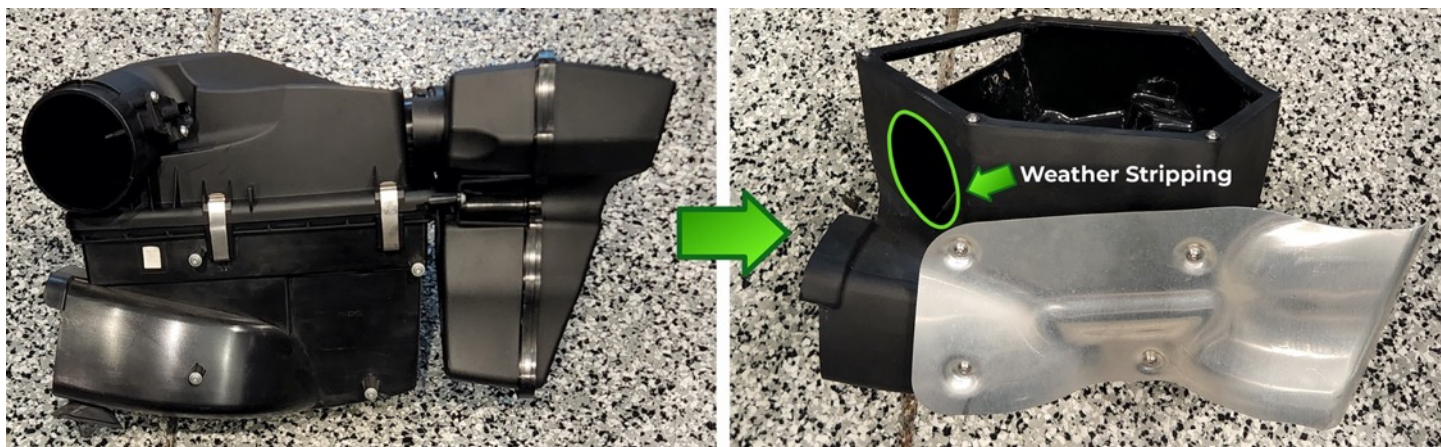

8. Put the outlet tube through the hole with the weather stripping on the airbox bottom and place and tighten the air filter securely on the other side.

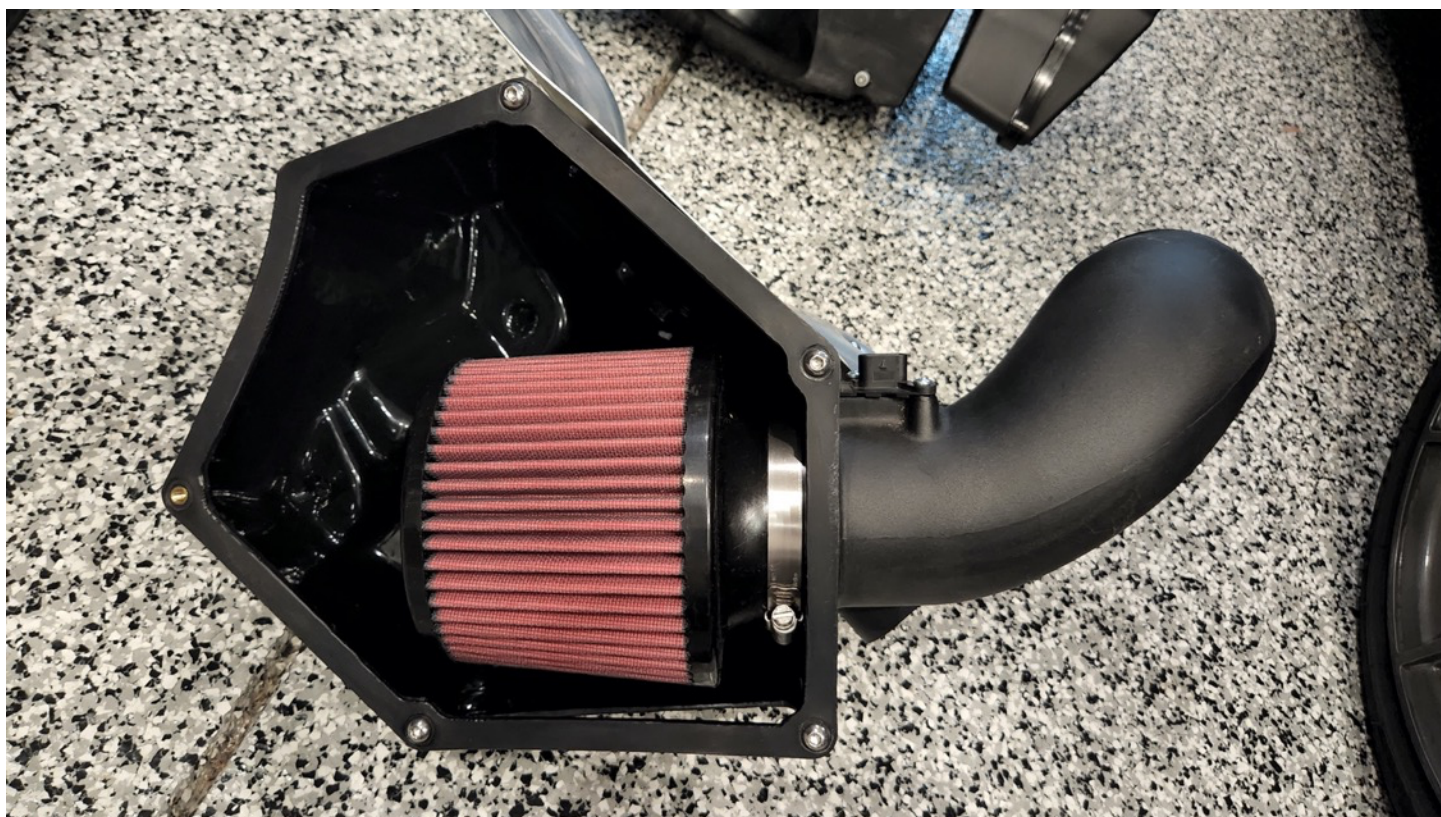



10. Attach the 4" silicone coupler to the turbo inlet and tighten the supplied lower clamp. Loosely place the top clamp on it.

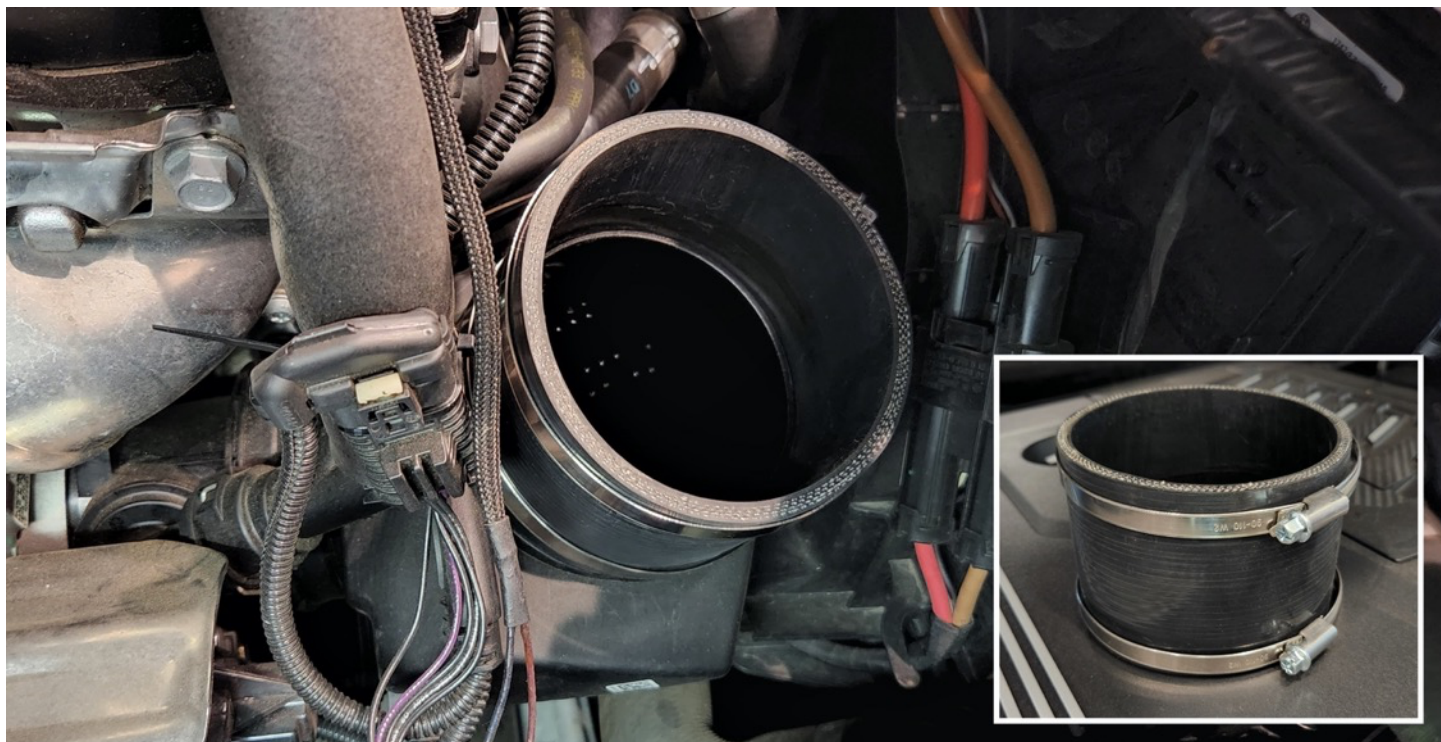

11. Place the BMS intake in the car into the rubber factory mounting supports. Align and push the intake outlet tube into the 4" silicone coupler and tighten the top clamp.

12. Attach the "MAF" temp sensor connector. Make sure it clicks and push the gray clip down.

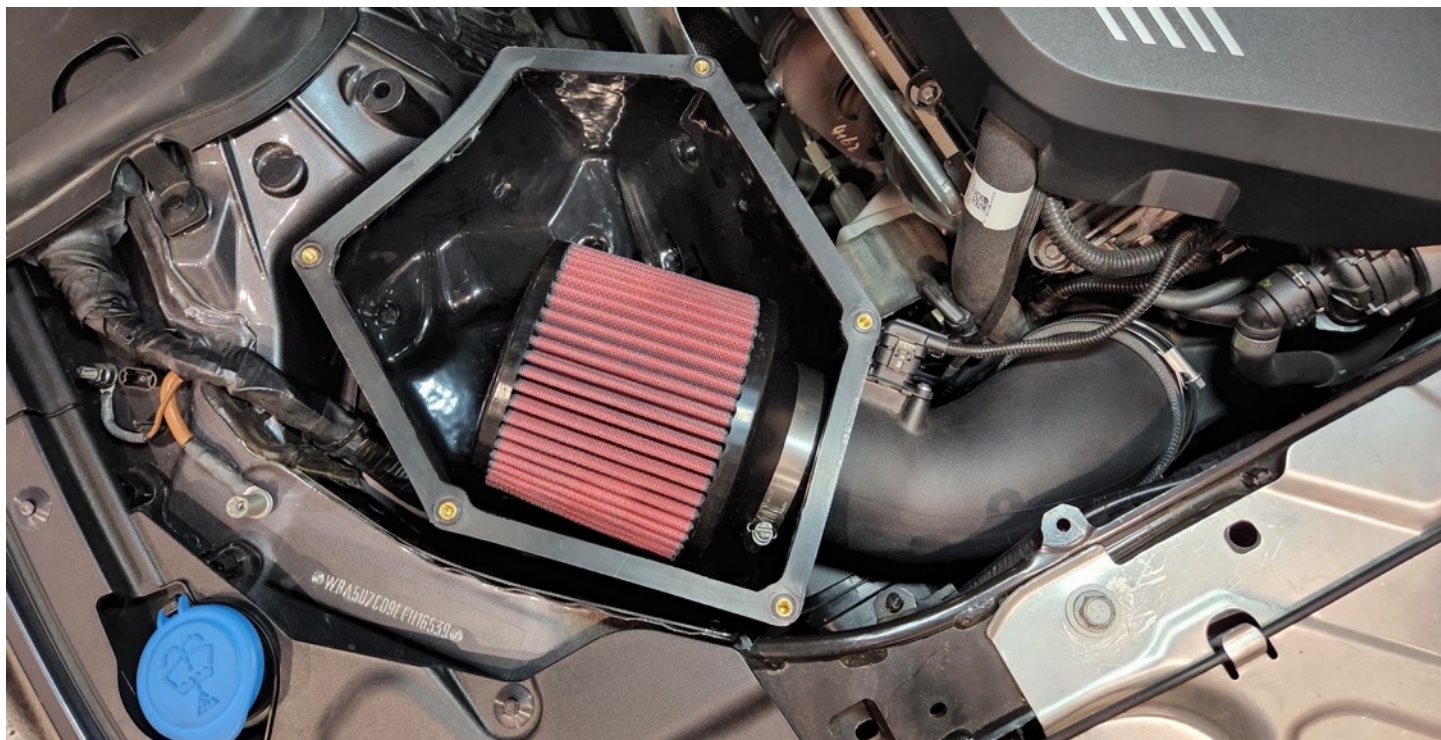



13. Place the airbox lid on top of intake airbox and tighten included the 5 hex screws. This intake is designed to work with OEM or [BMS Billet Strut Braces](#) and the [BMS B58 Oil Catch Can](#). Shown below.



Available parts and accessories.

[Filter cleaning and oiling kit](#) and [replacement \(1123\) filters](#).

